

OPERATING INSTRUCTIONS

BIG RED GREENHOUSE HEATER ALP-229









HOW TO TAKE CARE OF THE WICK

1. The wick is made of glass fiber and does not need to have its top cut off from time to time.
2. When the heater has been used for a long time, a tar-like substance is deposited on top of the wick. This substance affects the sucking up of fuel and the vertical movement of the wick. This tar-like substance can be removed by following these steps: Don't fill oil onto the heater even after the fuel indicator has indicated "0" (zero) fuel-level. Let the flame continue until the flame dies out by itself. By this time the tar-like substance on the top of the wick will have been consumed allowing for a better sucking up of oil and more smooth movement of the wick.
3. You do not need to worry about the wick being destroyed by the above burning idle, as it is made in glass fiber.

You should practice this idle burning of the wick once in 20 to 30 days.

HOW TO EXCHANGE THE WICK

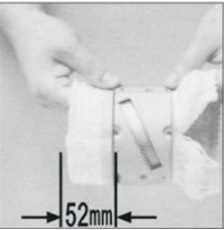
<ol style="list-style-type: none">1.2.	<p>Remove the protective frame by unscrewing the three fixing nuts.</p> <p>Remove the chimney</p>	
<ol style="list-style-type: none">3.	<p>Pull off the wick cover by unscrewing the four fixing nuts.</p>	

4.	Loosen the wick-adjustment-handle nut on the wick-adjustment-handle by turning it counter-clockwise and pull the wick-adjustment-handle towards you.	
5. 6. 7.	Pull up the wick holder together with the wick Clean the wick guide, burner, cover etc. Remove the old wick from the wick holder	
8. 9.	Insert a new wick inside the wick holder and let the wick stuck by the pricks inside the wick holder: The top of the wick shall be evenly exposed above the top of the wick holder. The wick holder lined with a wick is then to be applied down the wick guide.	
10. 11.	Get the wick holder in gear with the tip of the wick-adjustment-handle. Turn the wick-adjustment-handle knob clockwise and lift the wick completely. If the top of the wick is not evenly exposed, make it even by means of a pair of scissors	
12.	Place the wick cover on the burner. When doing this take care that the gap between the wick cover and the wick guide is made even. Otherwise the vertical movement of the wick will be obstructed.	
13.	To ensure a fine combustion it is essential to use a genuine wick for paraffin heaters.	

TROUBLES CAUSES AND MEASURES

Simple trouble causes, and measures are listed below. Check each item to find out the applicable measures corresponding to the defect items

First read the instruction to be familiar with how to handle and use the heater.

Checklist and precautions

- When using the heater, it must always be under supervision
- Only use kerosene in the heater
- Store fuel only in a safe place
- Never use the heater indoor or near other flammables
- Do not use the heater in a windy location
- Do not place the heater on an uneven surface
- Be cautious not to overfill or spill kerosene. If kerosene is spilled it must be wiped up immediately
- Only fill in kerosene when the heater is cold
- When relocating the heater, ensure that the flame is completely off
- Refill fuel before the tank runs empty
- Ensure that the flame is completely out, when the heater is not under supervision
- Ventilation may be required every 2-4 hours if the heater is used in tightly closed rooms
- Avoid bumping or upsetting the heater. Simply set it upright again if the heater should be accidentally overturned.

In case of fire extinguish the fire by covering it with a blanket or similar or extinguish the fire by using a fire extinguisher – DO NOT try to extinguish the fire by spraying water upon the heater.

Due to the characteristics of the fuel involved, it is important not to use water to extinguish the flames. In most cases, a spray of water would not reduce the heat, but would actually serve to spread the fuel farther, causing more damage. Smothering the flames and reducing the oxygen supply is the best method of combat against this type of fire.

HOW TO FILL THE TANK

- Unscrew the tank lid and fill in fuel by using a funnel until the fuel gauge indicates F (Full). Be cautious not to overfill. Overspilling increases the risk of fire and the kerosene has a bad smell.
- Refill fuel before the tank runs empty (the indicator shows E).
- Do not forget to put on the tank lid again.



COMPONENT PARTS

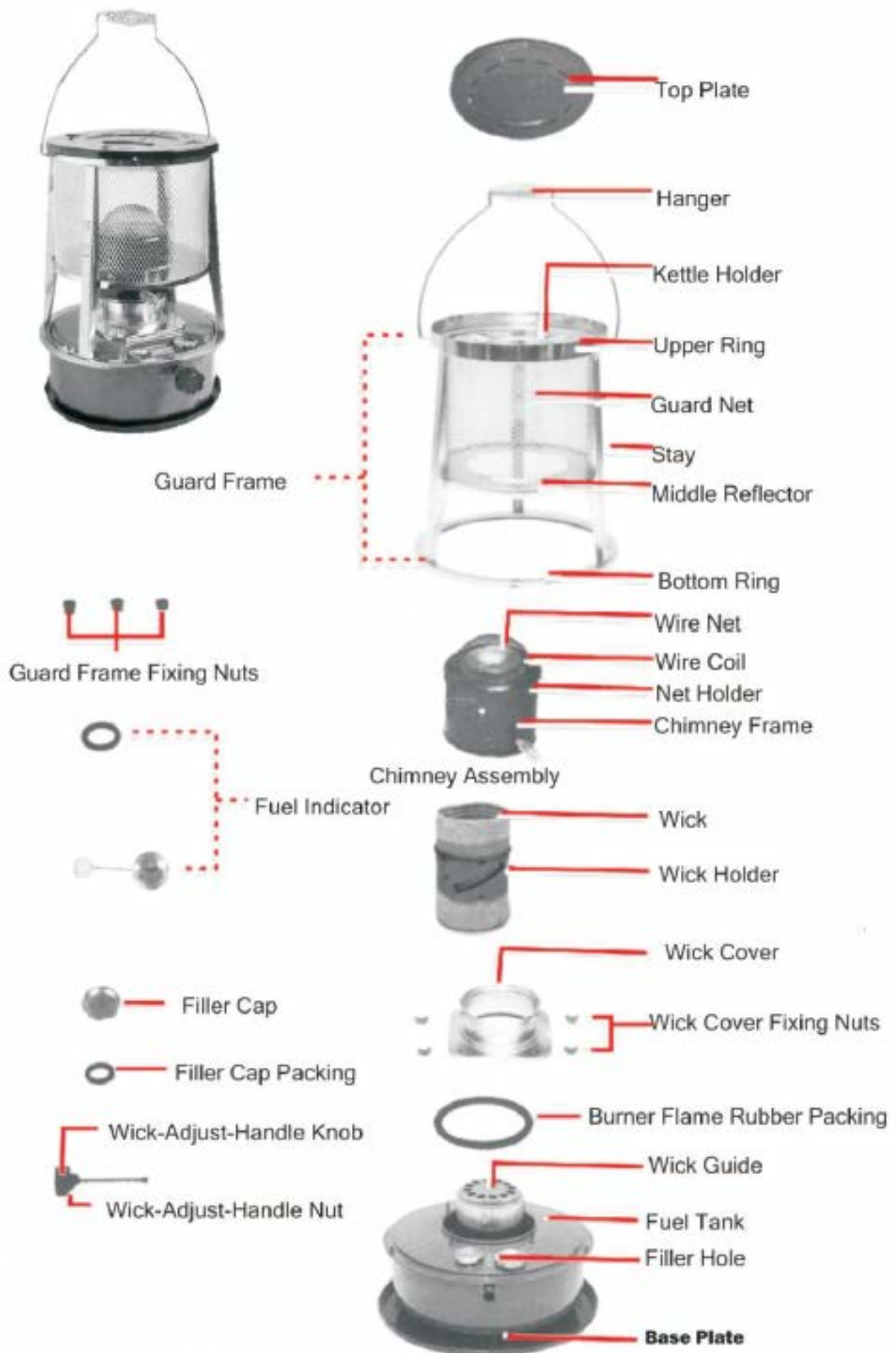

CAUTIONS WHEN ASSEMBLING THE HEATER

- In case there is water or dirt in the fuel tank, turn the heater upside down and shake it a few times and afterwards rinse the tank by flushing it with pure kerosene.
- When fitting the wick-adjustment-handle take care not to fasten the handle too tightly
- The rubber gasket (packing) on the bottom of the burner is never to be removed.



CAUTIONS

- The heater should only be used on a horizontal level
- The heaters should not be used in windy or draughty conditions
- The heater should not be used near inflammables
- If the heater is used in a room, the room shall have sufficient ventilation
- Users are requested to pay special attention to children when the heater is being used

STORING OFF SEASON

- Disassemble and clean the heater before storing it away
- The wick should be kept apart from the wick holder and the fuel tank
- The heater should be stored in an airy and dry place.

SPECIFICATIONS

Brand and model	Kerosene Space Heater
System	Lamp-wick system
Type	Radiation, red-heated, round type
Net weight (empty)	4 kgs
Tank-capacity	4.4 litres
Wick type	Incombustible, glass fiber wick, 2.6 ± 0.2 mm thick, 95 ± 0.2 mm inside diameter, 170 ± 0.5 mm long
Fuel consumption	0.2 – 0.25 litre per hour
Heating effect	1,900 – 2,200 Kcal per hour
Fuel to be used	White lightning kerosene No. 1

HOW TO IGNITE THE HEATER

When the heater is to be used for the first time, it is important that you start by filling the tank with kerosene and then you wait at least ten minutes allowing the wick to soak with fuel.

To ignite:

1. Lift the wick by turning the wick-adjustment-handle knob clockwise
2. Tilt the chimney by pinching the chimney knob
3. Light the wick with a match at two or three spots
4. Turn the chimney horizontally using the chimney knob, thereby setting the chimney properly on the burner



HOW TO ADJUST COMBUSTION



If the wire net on top of the chimney is brightly red-heated the combustion functions correctly



If flames flare up over the wire net, the wick is too high

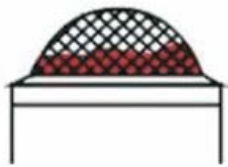

If the wire net is dark, the wick is too low or the fuel is short.

HOW TO EXTINGUISH

- Turn the wick-adjustment-handle knob counter-clockwise until it stops
- Make sure the fire has been extinguished
- Never fail to extinguish the fire before you move the heater to another place and before you leave the room in which the heater is used.

FEATURES

- The fiber glass wick which is incorporated in this heater is highly heat-resistant and durable
- The upper reflector which sends the heats downwards
- Safety is ensured by the designed protection frame
- The chimney made of stainless steel is long-time durable

USERS ARE REQUESTED TO OBSERVE THE FOLLOWING:

- Fill this heater with white lighting kerosene. No other fuel should be filled into this heater
- Fuel is to be stored in a safe place
- This heater should not be used in a narrow space or near inflammables
- This heater should not be exposed to wind or draughts
- This heater is to be used on a horizontal level
- Care should be taken not to spill kerosene. If spilt, then wipe it out immediately.
- Before you fill in kerosene or before you move the heater to another place, you must extinguish the heater.
- Burn the wick thoroughly once in every 20-30 days. How to burn the wick is described earlier in this manual.
- Do not sleep in a room where the heater is burning.
- Ventilate from time to time the room in which the heater is used.

NOTICE: USE ONLY BEST QUALITY LIGHTING KEROSENE